

Hangers and Hardware

For HD Drop-in Legrests (Updated Configuration)

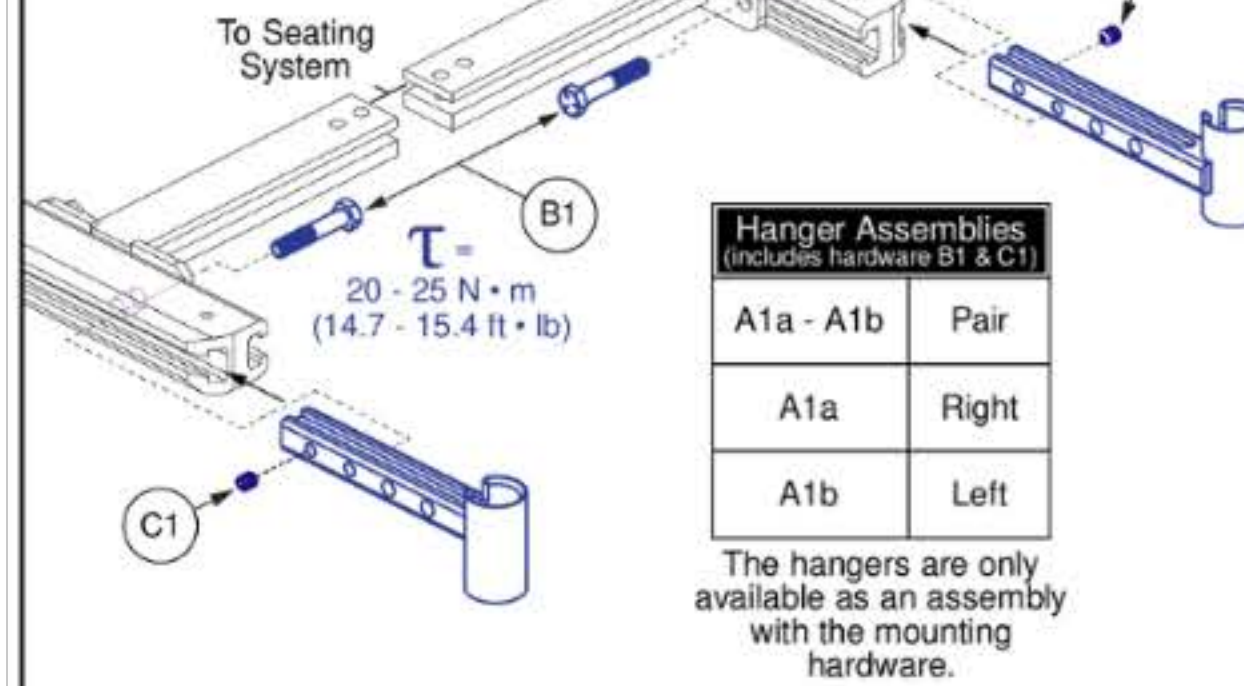

Please Note:



- The updated Drop-in hanger mounting hardware replaces the previous configuration shown below.
- Visually inspect the unit prior to replacing any components. If the unit is equipped with the previous configuration, follow the *Replacement and Installation* steps as outlined.
- The left and right hangers should always be installed in the same configuration. A mismatch of hardware and mounting should never occur.
- The width adjustment brackets shown may differ in appearance between TB3 seating systems.

Contact Technical Service for more information.

Replacement and Installation

Previous HD Drop-in Hanger Configuration

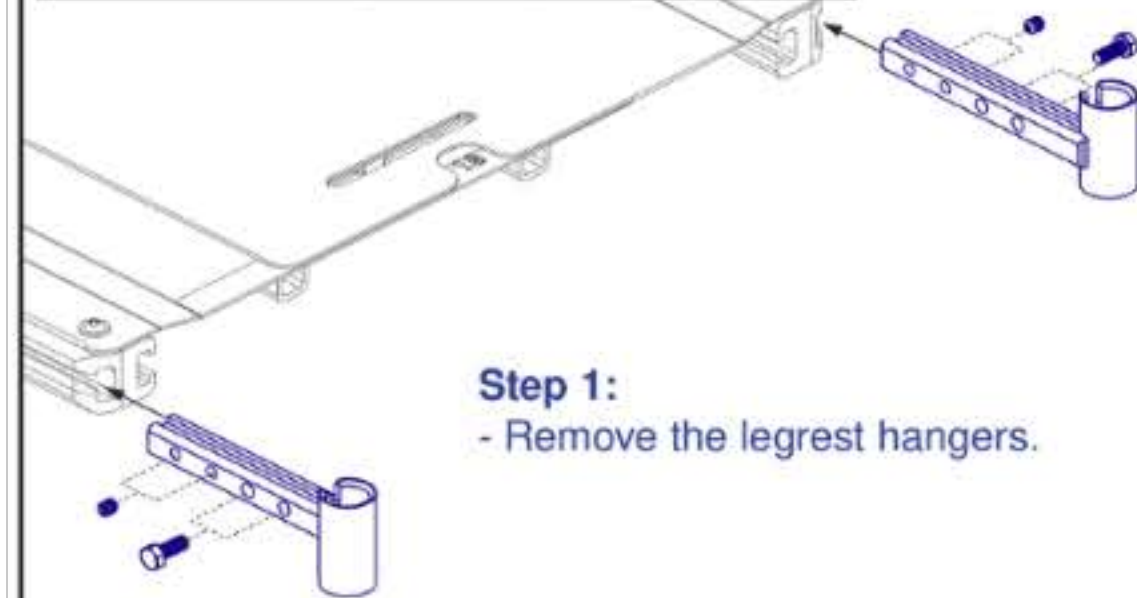

Front Width Adjustment Hardware Removal

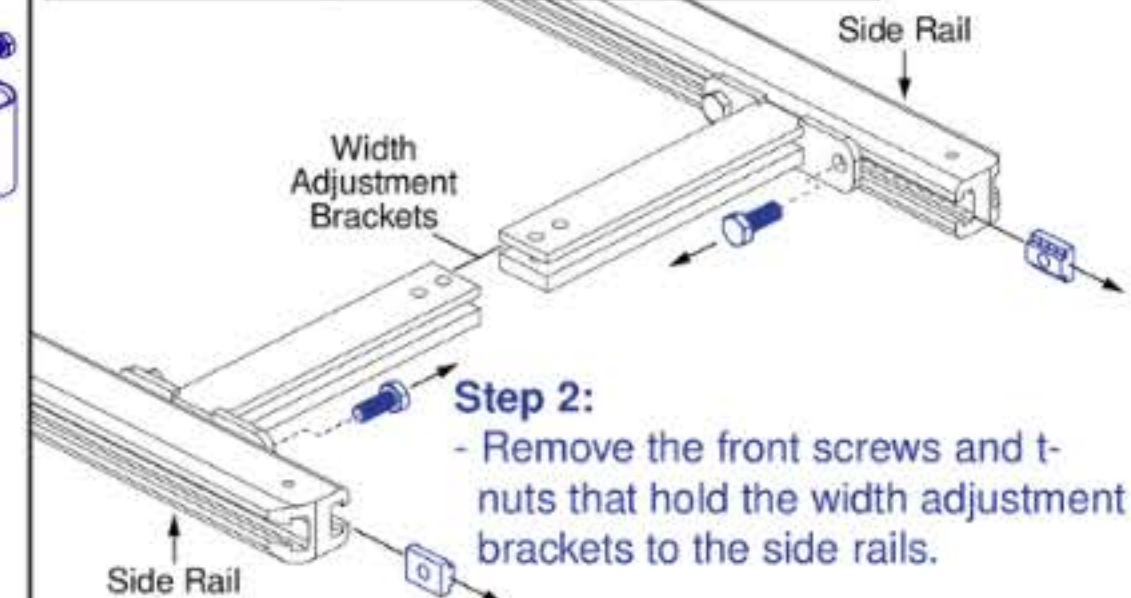

Note: Seat pan shown removed for illustration purposes only.

New Hardware Installation

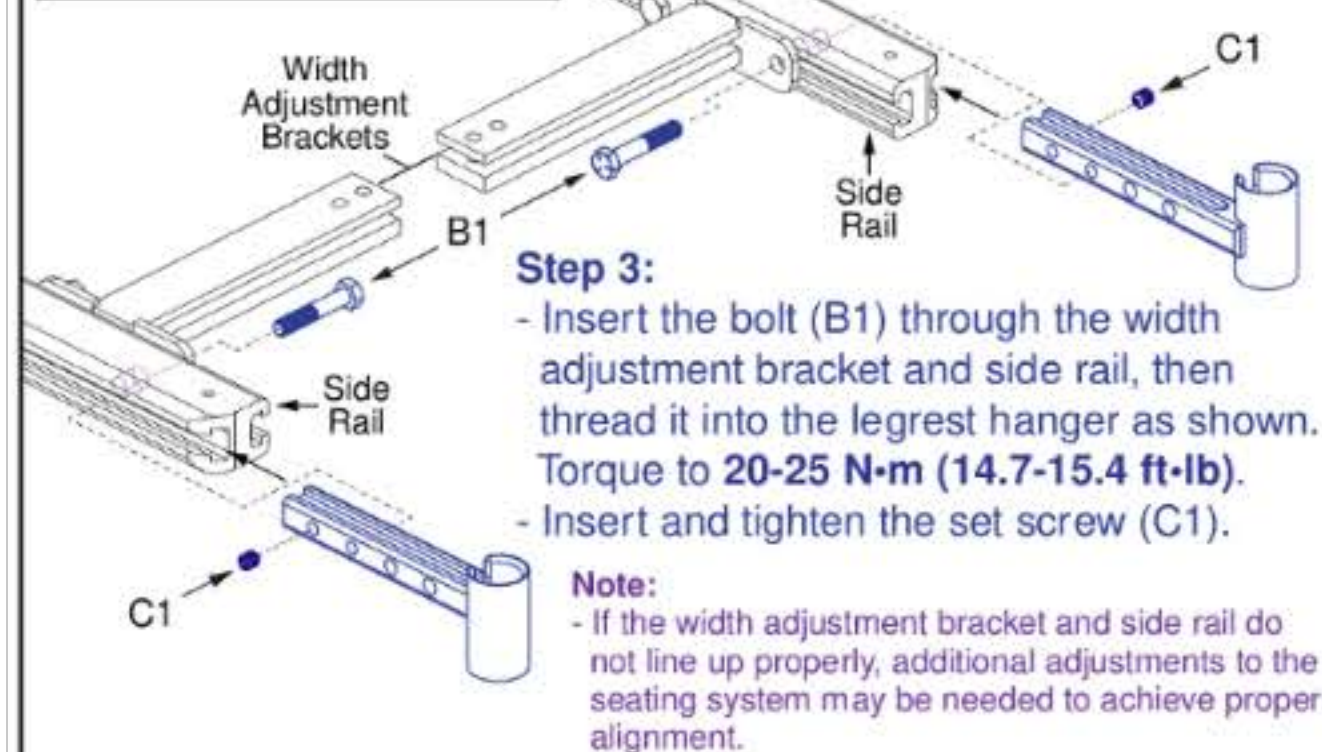

Note: Seat pan shown removed for illustration purposes only.

Additional Information

- The set screw and bolt mounting hole locations can be swapped to bring the hanger out an additional inch if needed.

